

(12) **United States Patent**
Dal Pra'

(10) Patent No.: **US 6,698,567 B2**
 (45) Date of Patent: **Mar. 2, 2004**

(54) **ELECTRIC CONTROL DEVICE FOR A MOTOR-DRIVEN DERAILLEUR FOR BICYCLES**

(75) Inventor: **Giuseppe Dal Pra', Zane (IT)**

(73) Assignee: **Campagnolo Srl, Vicenza (IT)**

(*) Notice: Subject to any disclaimer, the term of this patent is extended or adjusted under 35 U.S.C. 154(b) by 0 days.

4,143,557 A	*	3/1979	Wakebe et al.	474/80
4,946,425 A	*	8/1990	Buhlmann	474/80
5,358,451 A	*	10/1994	Lacombe et al.	474/78
5,470,277 A		11/1995	Romano	
5,479,776 A		1/1996	Romano	
5,480,356 A	*	1/1996	Campagnolo	474/70
5,494,307 A	*	2/1996	Anderson	280/236
5,514,041 A	*	5/1996	Hsu	474/78
5,653,649 A		8/1997	Watarai	
5,728,017 A	*	3/1998	Bellio et al.	474/70
5,865,454 A	*	2/1999	Campagnolo	280/238
6,015,036 A		1/2000	Fukuda	

(21) Appl. No.: **10/165,117**

(22) Filed: **Jun. 7, 2002**

(65) **Prior Publication Data**

US 2003/0019712 A1 Jan. 30, 2003

(30) **Foreign Application Priority Data**

Jun. 8, 2001 (IT) TO01A0555

(51) Int. Cl.⁷ **B62M 25/08**

(52) U.S. Cl. **192/217; 192/226; 74/502.2; 74/489**

(58) Field of Search **74/502.2, 489, 74/473.12, 473.13; 192/217, 226; 474/78, 80, 82; 280/238, 261; 200/61.87, 61.91**

(56) **References Cited**

U.S. PATENT DOCUMENTS

4,071,892 A * 1/1978 Genzling 701/200

* cited by examiner

Primary Examiner—Saul Rodriguez

(74) *Attorney, Agent, or Firm*—Volpe and Koenig, P.C.

(57) **ABSTRACT**

An electric control device for a motor-driven derailleur for bicycles includes a supporting body fixed to a handlebar of a bicycle, a supporting body, a pair of electric switches to control the gear change carried by the supporting body, and a gear change lever that can be manually operated to control a first of said switches. The gear change lever comprises a first part connected to the supporting body so as to consent shift of the gear change lever between a position at rest and an operating position, and a second part hinged to the first part.

50 Claims, 12 Drawing Sheets

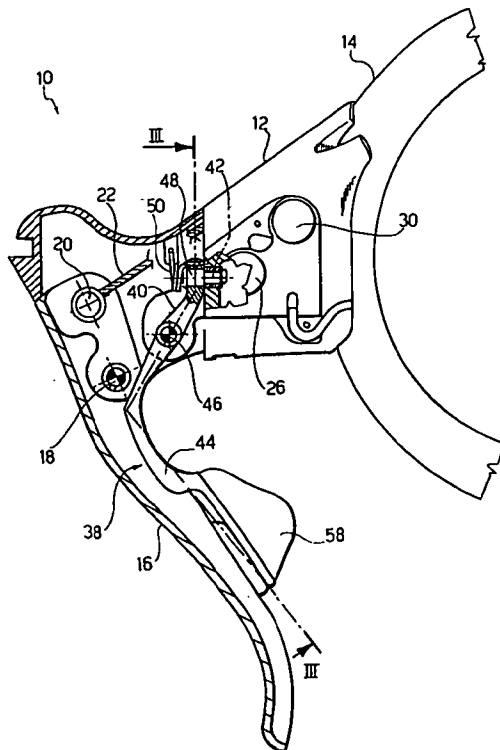

BEST AVAILABLE COPY